

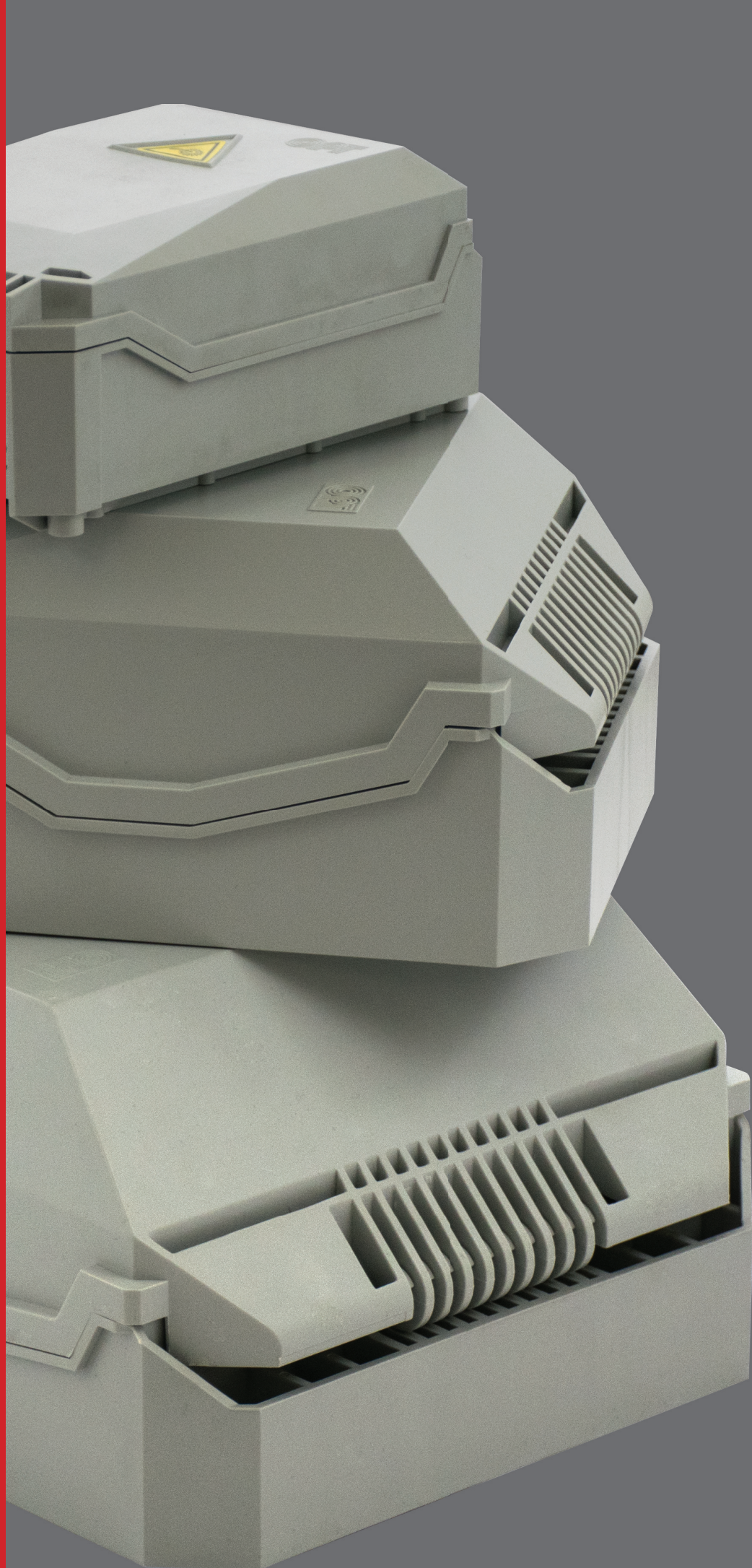

OPT-C-2020-01

FOCUS NGB S NGB SL  
FOCUS NGBKIT

ENGLISH





# FIBRE OPTIC CONNECTING UNIT *SYSTEM*



Optotek Focus Solutions are a complete approach to fibre management for the FTTH networks.

It goes far beyond offering a catalogue of components or individual building blocks. It is a comprehensive set of integrated products, services, and support to ensure the successful and efficient implementation of a fibre network that will serve as a stable communications infrastructure for many years to come.

Optotek FOCUS solutions include both a complete end to end products offering and design-through-operation services to ensure an easy fibre managing solution implementation.

The broad scope of Optotek's products line allows one-stop shopping.

Fiber optic products' for Central Office includes racks, shelves, termination boxes all with cassettes and trays to manage single circuits and single elements solutions. Outside plant products include outdoor cabinets, joint closures (aerial, buried), field installable connectors, patch-cords, splice components, engineering services and training.

At the premises end Optotek offers solutions to all typical lay-out; from out-lets terminations to small wall mount boxes, splice fusion protection sleeves, mechanic splices devices, field-mountable connectors, equipments for installation.

FBT, PLC and patch-cords filters are completing a wide range of products for all passive solutions.

# NGB NEXT GENERATION PATCH AND SPLICE BOXES



**FOCUS NGB line**, designed with simple and innovative design appealing and linear look, **properly fits PON and FTTH needs**. Reliable and **able to match the highest international quality standard** (IEC 61753) in order to operate in C (controlled) – G (outside) – A (aerial) categories.

**Suitable both for internal** (buildings, technical rooms...) **and external application** (wall, pole, cabinet, pedestal...), they can be used **in dust and water presence**.

The **full selection of available accessories** allows the management of different types of cables and fibers (G652 and

G657), besides the possibility to obtain different versions of sole splicing or both patch and splice.

By using **FOCUS SAM modules** it is possible to **match different splice capacity**, applying some protection systems both mechanical (FIBERCLIP) and heat-shrinkable (FIBERTERM). Moreover the **boxes** are designed for **allocating the patching systems with** the main common **connectors** on the market, in addition to the locally **mounted ones, PLC and optical reflectors**.

**FOCUS NGB series is featured by** a variety of **lock security systems** against accidental or unauthorized openings.

## APPLICATION

Access network subscriber termination

Optical distribution premises box

TLC - FTTH - PON networks

## TECHNICAL FEATURES

Reliable – international standards

Multifunctional – patch, splice or both

Compact – highest performance in minimum space

Multitasking – internal and external application

Easy installation – simple and with a full accessories' selection

Flexible – customized

Approachable - costs/benefits



MAX SIZE. IN mm		
Width	Height	Depth
216	325	125
165	255	110
110	170	70

### \* Integrated pole fixing system

**FOCUS-NGB-BASE (empty version)** includes these items:

- 1 Base
- 1 Cover
- 1 Cover foam gasket
- 1 Laser beam label 25mm
- 4 Fishers' screw anchor
- 1 Screw (NGB0)
- 2 Latch assembly (NGB1 and NGB2)
- 2 Cover locks (NGB1 and NGB2)

# NGB0-S and NGB1-SL

The sole splice boxes in the NGB0 S and NGB1 SL versions allow to splice a high fiber amount in a small space. Compact, functional, quick&easy to install, they represent the safest and most versatile solution in the FTTX networks. In the inside, it is possible to splice, protect and manage the fibre, both the G652 (radius min= 30mm) and the low bending G657 (radius min=20 mm) ones and to allocate the uncut cables (loose tubes). A full accessories set for the management of the input and output optical cables is available.

## TO UNDERSTAND OPTOTEC'S MODULES CONCEPT

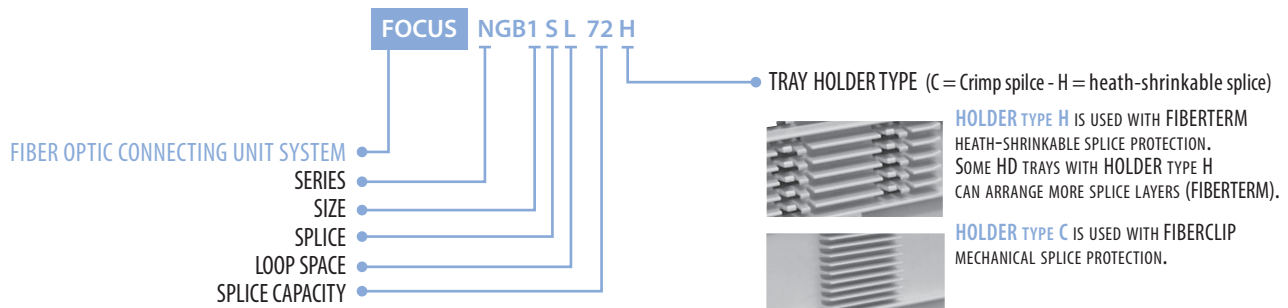

NGB 0 boxes only are equipped with an integrated system for mounting on pole. For NGB 1 and NGB 2 boxes pole mounting, it is recommended to order separately also the **FOCUS-NGB KIT-PMK**.

### BOX FOCUS NGB0 S 48H

BOX **NGB**  
SIZE **0**  
SPLICE ONLY **S**

**48H**  
4 TRAYS RHD TYPE FOR SPLICE ONLY  
WITH HOLDER TYPE H FOR FIBERTERM SPLICES  
(12 SPLICES PER TRAY)

MAX. NUMBER CABLE ENTRY  
(IN + OUT) 3



### BOX FOCUS NGB1 SL 72H

BOX **NGB**  
SIZE **1**  
SPLICE ONLY **S**

**L**  
AREA DEVOTED TO THE ALLOCATION  
AND MANAGEMENT OF THE UNCUT CABLE

**72H**  
6 TRAYS RHD TYPE FOR SPLICE ONLY  
WITH HOLDER TYPE H FOR FIBERTERM SPLICES  
(12 SPLICES PER TRAY)

MAX. NUMBER CABLE ENTRY  
(IN + OUT) 3

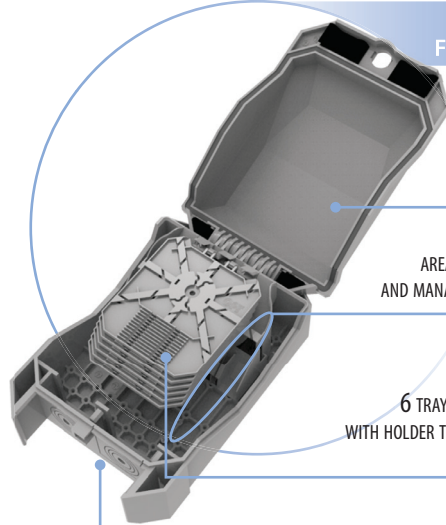

## HERE BELOW NGB-S AND NGB-SL OPTOTEC'S PROPOSAL

REFERENCE PN	DESCRIPTION
FOCUS-NGB0-S-48H	NGB Box - size 0 - SPLICE only. This box includes 4 trays RHD with holder H for FIBERTERM splices. (Splices per tray: 12 - Tot. splices per box: 48)
FOCUS-NGB0-S-24C	NGB Box - size 0 - SPLICE only. This box includes 2 trays RHD with holder C for FIBERCLIP splices. (Splices per tray: 12 - Tot. splices per box: 24)
FOCUS-NGB1-SL-72H	NGB Box - size 1 - SPLICE and cable LOOP space. This box includes 6 trays RHD with holder H for FIBERTERM splices - (Splices per tray: 12 - Tot. splices per box: 72)
FOCUS-NGB1-SL-72C	NGB Box - size 1 - SPLICE and cable LOOP space. This box includes 6 trays RHD with holder C for FIBERCLIP splices - (Splices per tray: 12 - Tot. splices per box: 72)



# CUSTOMIZABLE NGB1-S NGB2-SL

The compact design and the multifunctional variety of FOCUS SAM trays allow the NGB1 and NGB2 boxes to be suitable to be customized in order to match clients' needs.

In the inside, it is possible to mount different splicing capacity modules up to 96 fibres/junctions per each.

NGB1-S and NGB2-SL versions allow a high fiber splicing capability, an easy management of the uncut cables (NGB2-SL), placing the uncut fiber tubes either on the right or on the left according to the installation needs.

## TO UNDERSTAND OPTOTEC'S MODULES CONCEPT

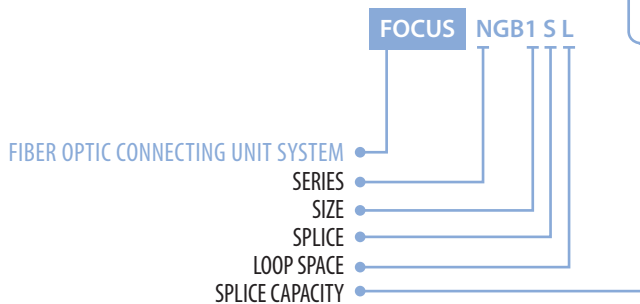

NGB SPLICE CAPACITY DEPENDS ON THE SPLICING MODULES QUANTITY AND TYPE NEEDS.  
IT IS WORKABLE TO COMBINE FOCUS SAM HD MODULES WITH WAP 6 OR WAP 4 HAVING BOTH THE SAME ENCUMBRANCE.

### SAMR HD FOR BOX NGB1-S

NGB1 S BOX CAN ACCOMMODATE A MAXIMUM OF 2 FOCUS-SAMR-HD MODULES WITH A WAP FOR 4 OR 6 TRAYS



### SAM HD FOR BOX NGB2-SL

NGB2 SL BOX CAN ACCOMMODATE A MAXIMUM OF 3 FOCUS-SAM-HD MODULES WITH A WAP FOR 4 OR 6 TRAYS



NGB 0 boxes only are equipped with an integrated system for mounting on pole.  
For NGB 1 and NGB 2 boxes pole mounting, it is recommended to order separately also the **FOCUS-NGB KIT-PMK**.

### BOX FOCUS NGB1 S

BOX **NGB**  
SIZE **1**  
SPLICE ONLY **S**

SUPPORT FOR  
CABLE TUBES  
ENTRANCE MANAGEMENT

MAX. NUMBER  
CABLE ENTRY  
(IN + OUT) 3

**UC**  
1 UNIVERSAL COVER FOR HD TRAY



### BOX FOCUS NGB2 SL

BOX **NGB**  
SIZE **2**  
SPLICE ONLY **S**  
**L**

AREA DEDICATED TO THE  
ALLOCATION AND MANAGEMENT  
OF THE UNCUT CABLE

SUPPORT FOR CABLE TUBES  
ENTRANCE MANAGEMENT

MAX. NUMBER CABLE ENTRY  
(IN + OUT) 3

**UC**  
1 UNIVERSAL COVER  
FOR HD TRAY

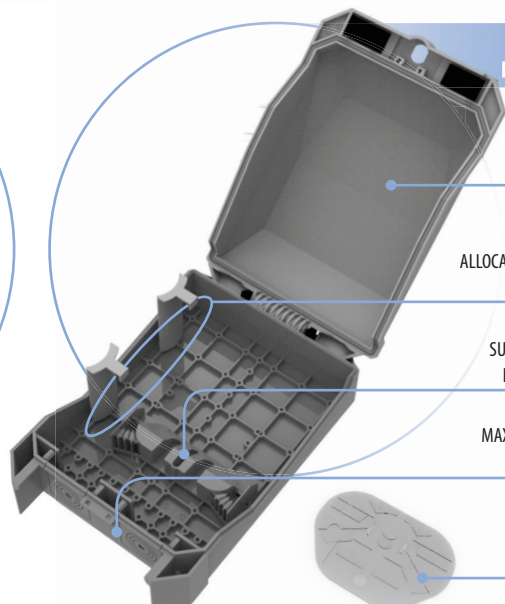

NGB1-S MAX. SPLICE CAPACITY	TOT. NO. OF MODULES	MODULE NAME
144	2	FOCUS-SAMR-HD6-12C
144	2	FOCUS-SAMR-HD6-12H
192	2	FOCUS-SAMR-HD4-24H

NGB2-SL MAX. SPLICE CAPACITY	TOT. NO. OF MODULES	MODULE NAME
216	3	FOCUS-SAM-HD6-12C
216	3	FOCUS-SAM-HD6-12H
288	3	FOCUS-SAM-HD4-24H

## HERE BELOW NGB-S AND NGB-SL OPTOTEC'S PROPOSAL

REFERENCE PN	DESCRIPTION
FOCUS-NGB1-S	NGB Box - size 1 - SPLICE only. This box includes arrangement cable entry system and 1 Universal Cover for 1 High Density tray belonging to series SAMR
FOCUS-NGB2-SL	NGB Box - size 2 - SPLICE and cable LOOP space. This box includes arrangement cable entry system and 1 Universal Cover for 1 High Density tray belonging to series SAM

[www.optotec.com](http://www.optotec.com)

CON CX CP OSP CO FOCUS

All the information included in this document, including drawings, illustration and patterns have to be considered reliable; they are registered and owned by Optotec S.p.A, therefore it is strictly forbidden to use them without our previous authorization. However, Optotec makes no warranties as to its accuracy or completeness and disclaims any liability in connection with its use. Optotec's obligations shall only be as set forth in Optotec's Standard Terms and Conditions of Sale for this product and in no case will Optotec be liable for any incidental, indirect or consequential damages arising out of the sale, resale, use or misuse of the product. Users of Optotec products should make their own evaluation to determine the suitability of each such product for the specific application.



via Bernardino Zenale, 44  
20024 Garbagnate Milanese (MI) - Italy  
ph. +39 02 99515 1 - fax +39 02 99515 222  
info@optotec.it

[www.optotec.com](http://www.optotec.com)